

Step 1. Power down the unit.

Step 2. Laying down a clean bar towel or microfiber cloth to protect the display, Place the tablet face down on a level workspace.

Step 3. Locate the pleather clip cover on the hand strap and lift-up the exposed lip to release the hook and loop seal.



Step 4. Press the exposed tabs on the compression clip to release the band

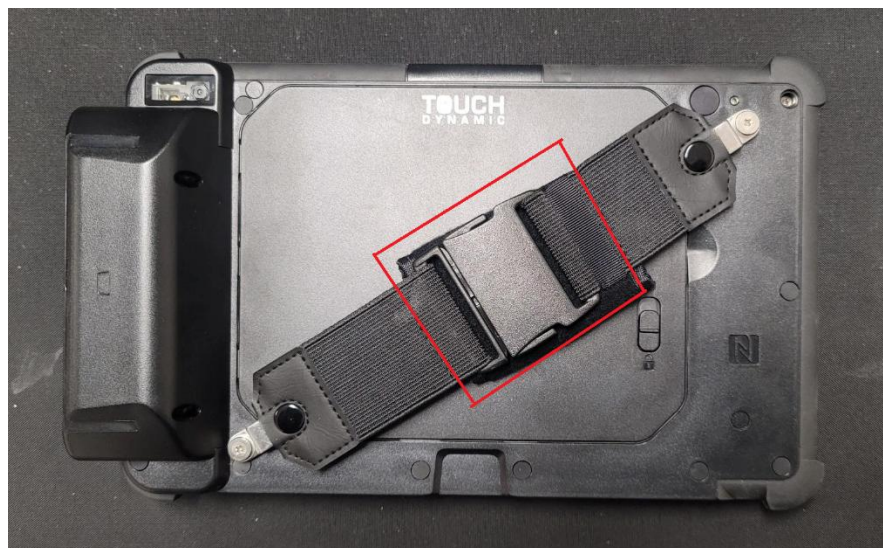

Step 5A Rotate the ends of the separated hand bands (A) away from the rear of the tablet to expose the battery door and locks.

Step 5B Verify the latches are moved to the unlocked position *Note: in the reference image the locks are in the upward unlocked position. You can also verify the latches are in the unlocked position with the red highlight.

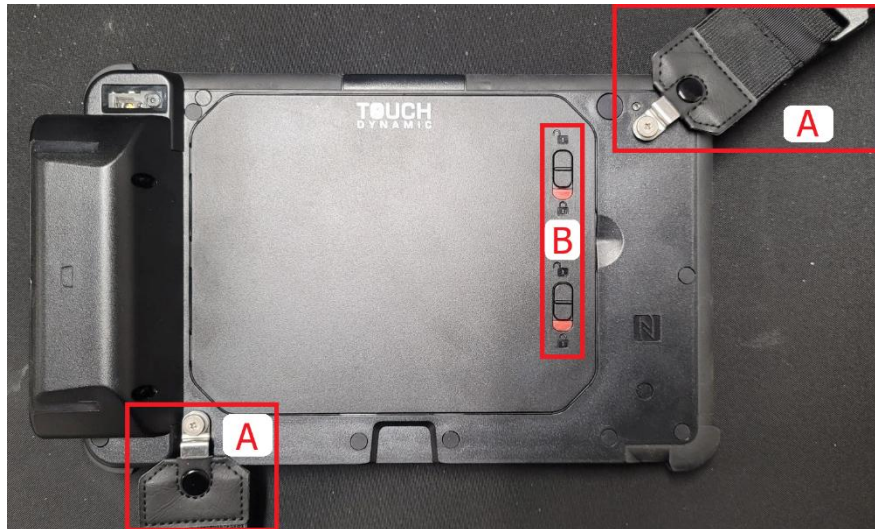

Step 6. Inserting a finger, plastic or nylon pry tool into point A, gently lift the door upwards and away to gain access to the battery compartment.

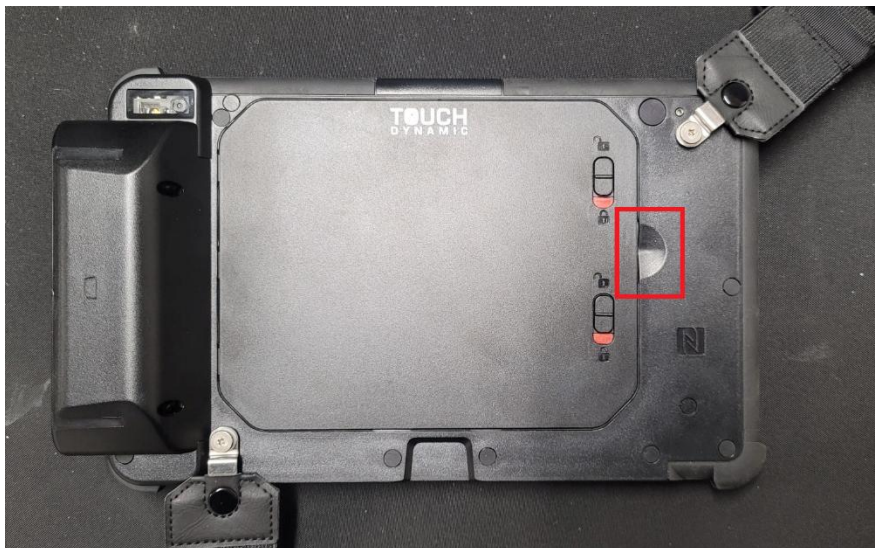

Step 7. With the battery tray door removed, firmly grip the battery pull tab, located towards the bottom of the battery and pull up and away from the rear of the tablet.

